

Specifications:  
Housing: LCP UL94-V0 Color: Nature  
Contact: Phosphor Bronze  
Operating Voltage: 100V AC/DC  
Current Rating: 1A AC/DC  
Withstand Voltage: 250V AC/Minute  
Contact Resistance:  $\leq 20m\Omega$   
Insulation resistance:  $\geq 100m\Omega$   
Operating Temperature:  $-25^{\circ}C \sim +85^{\circ}C$

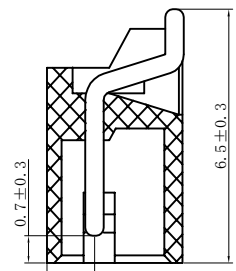

NO. of Contacts (n)	Dimensions		
	A	B	C
002	1.5	2.9	6.1
003	3.0	4.4	7.6
004	4.5	5.9	9.1
005	6.0	7.4	10.6
006	7.5	8.9	12.1
007	9.0	10.4	13.6
008	10.5	11.9	15.1
009	12.0	13.4	16.6
010	13.5	14.9	18.1
011	15.0	16.4	19.6
012	16.5	17.9	21.1
013	18.0	19.4	22.6
014	19.5	20.9	24.1
015	21.0	22.4	25.6
016	22.5	23.9	27.1
017	24.0	25.4	28.6
018	25.5	26.9	30.1
019	27.0	28.4	31.6
020	28.5	29.9	33.1

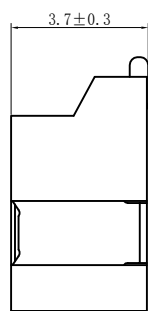
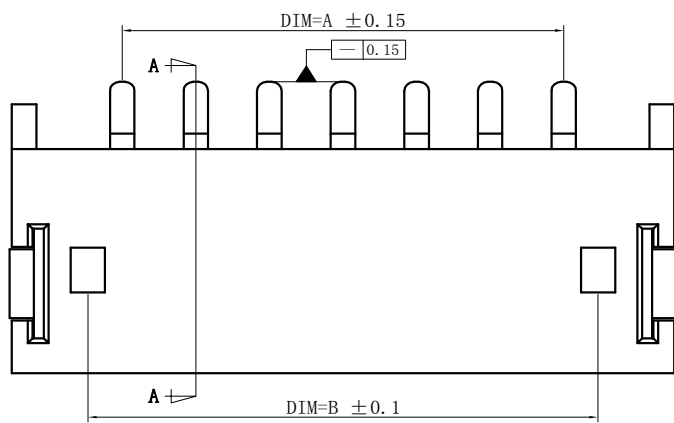
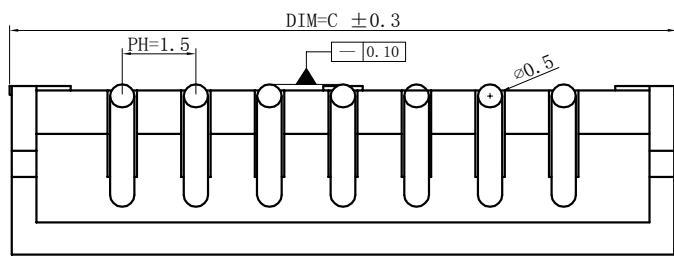
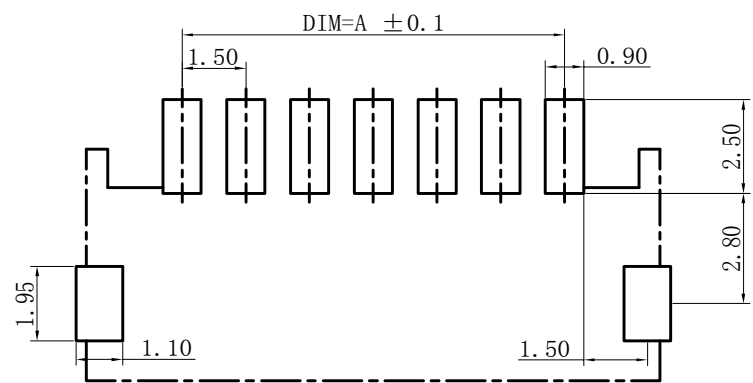

P. C. B LAYOUT REF

一般公差  
TOLERANCES  
X.  $\pm 0.40$  .XX  $\pm 0.20$   
.X  $\pm 0.30$  .XXX  $\pm 0.10$   
ANGLES  $\pm 2^{\circ}$

检验尺寸标示  
SYMBOLS  $\odot$   $\ominus$  INDICATE CLASSIFICATION DIMENSION

$\odot$  MARK IS CRITICAL DIM.  
 $\ominus$  MARK IS MAJOR DIM.

表面处理 (FINISH)

深圳市宏利电子有限公司  
Shenzhen Holy Electronic Co.,Ltd

工程图号	ZH15TB-nP	制图 (DR)	'08/5/16
品名	ZH1.5mm -nP 卧贴	审核 (CHKD)	
TITLE	ZH1.5mm Pitch TB FOR SMT CONN	核准 (APPD)	Rigo Lu
比例 (SCALE)	1:1	单位 (UNITS)	mm
张数 (SHEET)	1 OF 1	尺寸 (SIZE)	A4
REV		REV	

修订 REV	修改摘要 REVISION DESCRIPTION	日期 DATE	签名 SIGNATURE
-	-	-	-